

CLIENT:	PLAN: P 8904	LOT AREA: 1055m ²	SURVEY DATE: 21/05/19
BUILDER:	C/T Vol: 37 Fol: 15A	MAP REFERENCE:	
BUILDER JOB #	HEIGHT DATUM: AHD	COASTAL ZONE: >1KM	
AUTHORITY: CITY OF STIRLING	HEIGHT CORRECTION TO AHD: NO	SEWER INFORMATION: YES	

FEATURE SYMBOL LEGEND

NOTES

- (1) ALL BUILDINGS & STRUCTURES TO BE REMOVED
- (2) PROPOSED LOT 401 AREA = 542m²
- (3) PROPOSED LOT 402 AREA = 513m²
- (4) ORIGINAL PARENT LOT 13 AREA = 1055m²
- (5) FOR CLARITY, TREE SPREADS ARE NOT SHOWN TO SCALE

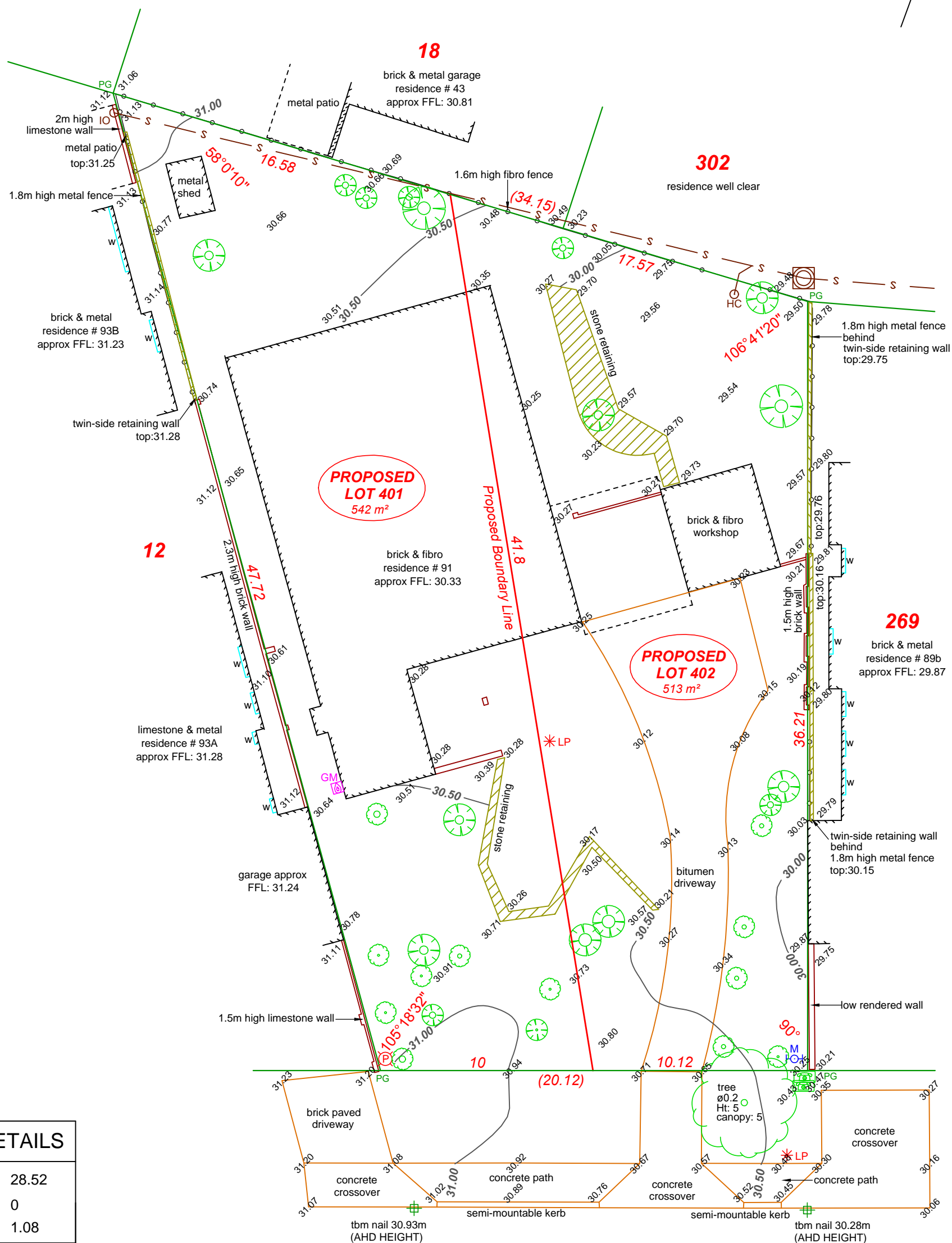

POWER

CABLE DOME	POWER POLE
CABLE BOX	CONSUMER POLE
POWER MARKER	EXPOSED CABLES
LIGHT POLE	EARTH ROD

WATER

WATER METER / TAP	FIRE HYDRANT
TAP	STOP VALVE
FLUSHING POINT	RETIC VALVE
BORE	WATER MARKER

SEWERAGE

SEWER M/H (SQUARE LID)	SEWER M/H (ROUND LID)
INSPECTION SHAFT	INSPECTION OPENING
HOUSE CONNECTION	

TELSTRA

TELSTRA PIT	TELSTRA MANHOLE
TELSTRA MARKER	

DRAINAGE

DRAIN M/H (SQUARE LID)	DRAIN M/H (ROUND LID)
SIDE ENTRY PIT	DRAINAGE GRATE
COMBINED ENTRY PIT	

GAS

GAS METER	GAS VALVE
GAS MARKER	

SURVEY MARKS

PEG FOUND	PEG GONE
DRILL HOLE	BENCH MARK
PEN MARK	NAIL & PLATE
	NAIL

MISCELLANEOUS INFO.

BIG TREE HEIGHT > 5m	SPOT HEIGHT
SMALL TREE HEIGHT < 5m	BOLLARD
OVERHEAD POWER LINE	SEWER LINE
FENCE LINE	WINDOW / OPENING

SERVICE DETAILS

WATER: L
 OVERHEAD POWER: NS
 U/G POWER: L
 TELSTRA: L
 GAS: L
 SEWER: L

SERVICE NOTES
 L: LOCATED NS: NO SERVICE
 A: AVAILABLE BUT NOT LOCATED
 TBC: LOCATION TO BE CONFIRMED

SEWER JUNCTION DETAILS

HOUSE CONNECTION (HC1) IL:	28.52
UP DISTANCE:	0
DEPTH TO CONNECTION:	1.08

SCALE 1:200 AT A3 SIZE

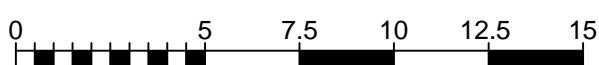

IMPORTANT FEATURE SURVEY NOTES

- The boundary information on this site plan is approximate only. The boundary has been positioned using a best-fit of available survey marks and fence lines. A repeg / bdy identification survey is recommended if an accurate position of features / improvements relative to the boundary is required.
- The sewer junction on this plan has been plotted using information provided by the Water Corporation. A site inspection is required by the builder / developer in order to verify the position and depth of the sewer connection.
- The lot dimensions shown on this feature survey plan have been taken from L.T.O survey plans. The final repegged dimensions may vary due to adjustments made during field survey.
- All service information shown of this plan should be verified with the relevant authorities.
- Pro West Surveying does not accept liability for any loss or damage caused by the use of this feature survey plan for any purpose.

BUNTINE ROAD
(bitumen)

DEPARTMENT OF PLANNING, LANDS AND HERITAGE

DATE	FILE
29-May-2019	158070